

EL Series DM25LE/L v3 with 3rd stop (2017,2018,2019)

P1 BUTTON

| P1 | STATE | ACTION | VISUAL CONFIRMATION | AUDIBLE CONFIRMATION | DESCRIPTION |
|-------------|----------------------------|---|---------------------|----------------------|---|
| SHORT PRESS | NO LIMITS ARE SET | NONE | NONE | NONE | NO ACTION |
| | LIMITS ARE SET | OPERATES MOTOR WITHIN LIMITS. STOPS MOTOR IF RUNNING. | MOTOR RUNS | NONE | OPERATES MOTOR WITHIN LIMITS AFTER PAIRING |
| | SLEEP MODE WITH LIMITS SET | WAKE AND RUN | MOTOR RUNS | NONE | MOTOR IS RESTORED FROM SLEEP MODE AND IS READY FOR USE. |

Activate Pairing Mode



Sleep Mode



Reverse Direction



Reset To Factory Settings



Hold P1

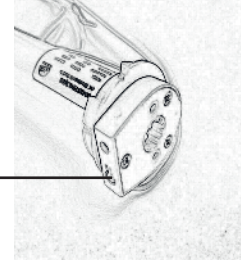

NOTE

Reverse motor direction from P1 button only when motor does not have any limits.

INITIAL SET-UP

Pair motor with controller

Select channel on controller. Hold P1 button on motor head.

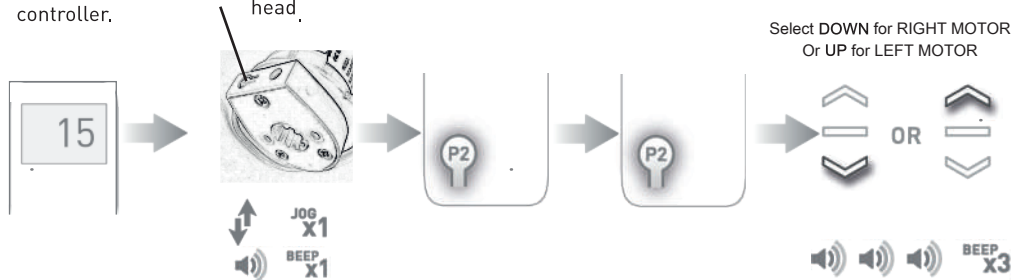

Motor is now in step mode and ready for setting limits

Check motor direction

To check travel direction of shade, press UP or DOWN on controller.



IMPORTANT

Reversing motor direction using this method is only possible during initial set-up.



IMPORTANT

Damage to shade may occur when operating motor prior to setting limits. Attention should be given.

To reverse shade direction, hold both UP and DOWN.

Until the motor responds



Set limits

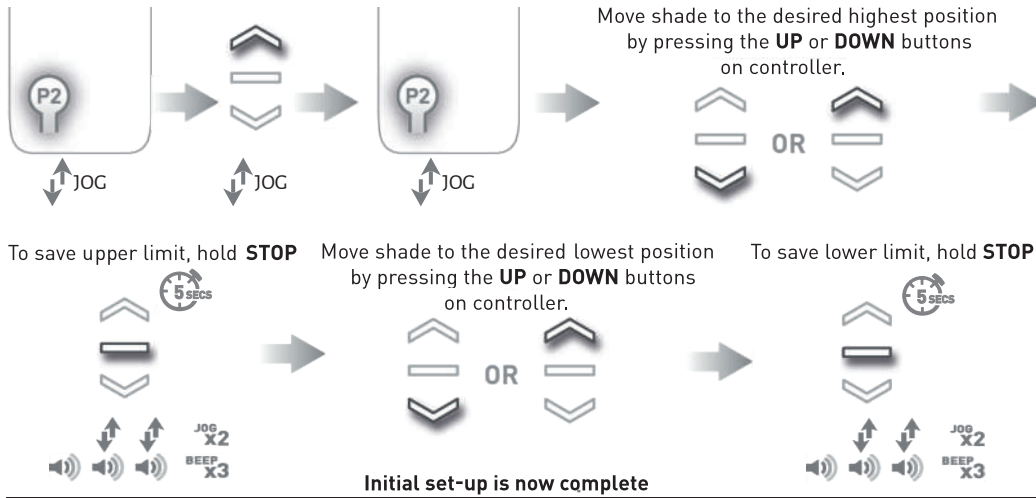

ADJUSTING LIMITS

Adjust upper limit

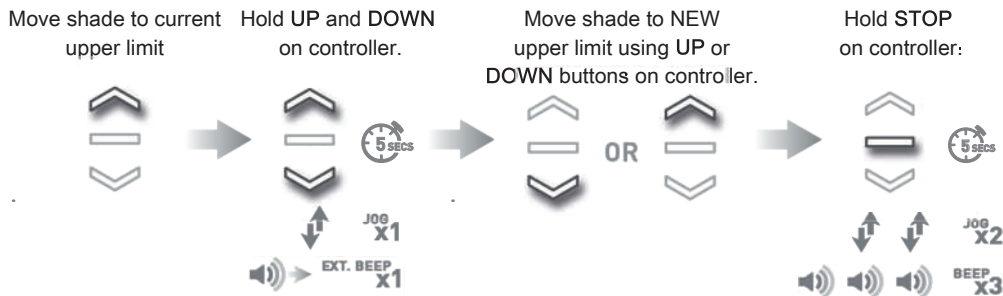

Adjust lower limit

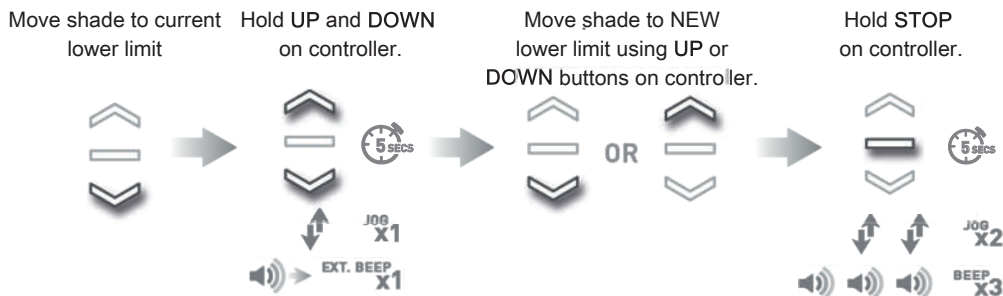

ADJUSTING MOTOR SPEED

Increase or decrease motor speed

To adjust motor speed, follow these three steps for each level of speed adjustment. There are three speeds available

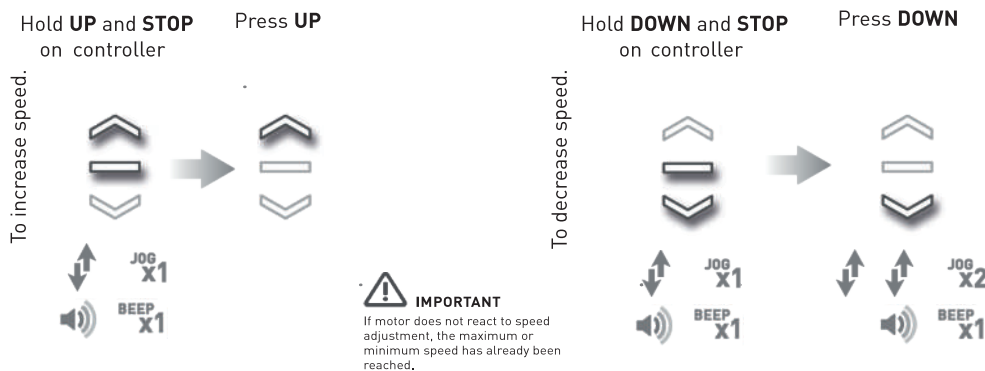

ADDING OR REMOVING CONTROLLERS AND CHANNELS

Using motor P1 button

Hold **P1** button on motor head

Hold **UP** on controller to add or remove



Using a pre-existing controller

A= Existing controller or channel (to keep)

B= Controller or channel to add or remove

Press **P2** on existing controller.



Press **P2** on existing controller.



Press **P2** on new controller.

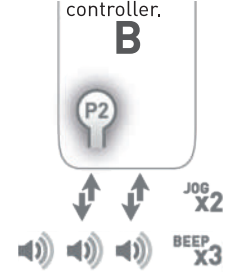

FAVORITE POSITIONING

Set a favorite position

Move shade to the desired position by pressing the **UP** or **DOWN** button on the controller



Send shade to favorite position

Hold **STOP** on controller



Delete favorite position

Press **P2** on controller.



Press **STOP** on controller.



Press **STOP** on controller.



TILT & ROLLER MODE

Enter tilt mode

For slat adjustment on venetians



Enter roller mode (Default)

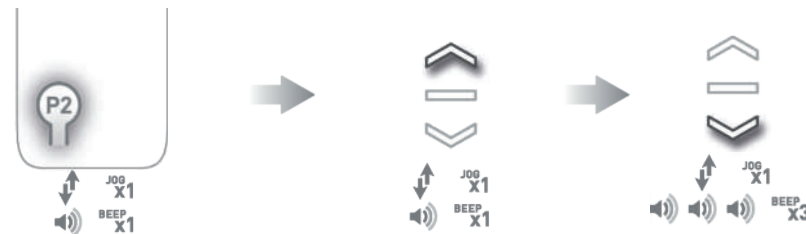

SLEEP MODE

Enter Sleep Mode

Sleep mode is utilized to prevent a motor from moving during shipping of a fabricated shade

Hold **P1** button on the motor head

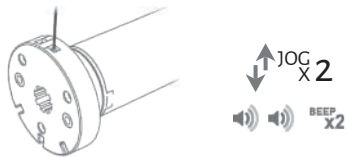

Exit Sleep Mode

Exit sleep mode once the shade is installed

Hold **P1** button on the motor head



TROUBLESHOOTING

| Problem | Cause | Remedy |
|---|---|--|
| Motor is not responding | Battery depleted | Replace or re-charge battery |
| | A/C power supply not plugged in. | Check power and connections |
| | Transmitter battery discharged | Replace battery |
| | Transmitter battery inserted incorrectly | Check battery polarity |
| | Radio interference/shielding | Keep transmitter away from metal objects and make sure antenna on motor is straight and away from metal |
| | Receiver distance is too far from transmitter | Move transmitter closer |
| | Power failure | Check power and power supply |
| Motor beeps 10 times when in use | Battery voltage is low. | Replace batteries in battery wand -OR- Recharge rechargeable battery pack. |
| | | Always reserve an individual channel for programming functions |
| Cannot program a single Motor (multiple motors respond) | Multiple motors are paired to the same channel. | SYSTEM BEST PRACTICE - Provide an extra 15 channel controller in your multi motor projects, that provides individual control for each motor for programming purposes |
| | | Place all other motors into sleep mode |